

MUO

1:1 Phase PF 0.9 Online UPS

Power range : 1kVA~3kVA



Features

- High power density
- Online double conversion with full digital control
- Wide input voltage range: 110~300Vac
- Input power factor 0.99 with PFC
- Selectable output voltage: 208/220/230/240Vac
- Smart charger design for optimized battery performance
- Maximum charging current can be expanded to 12A (Long run unit)
- Emergency power off function (EPO)
- ECO mode operation for energy saving
- Generator compatible
- Cold start
- Intelligent fan speed regulation
- Load segment settable (Optional)
- Versatile LCD human-computer interface
- Multiple communication interface: RS232 (USB/EPO/Relay card /SNMP card optional)
- Multiple protection function: short-circuit, overload, overheat, battery overcharge and overdischarge, output low voltage and fan fault alarm

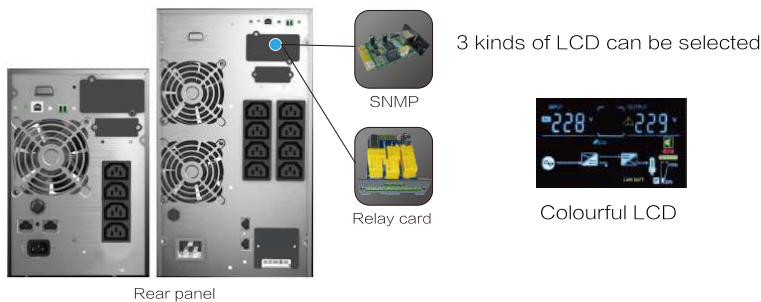

Rear panel



MUO-1000

MUO-2000
MUO-3000

Technical Specifications:

MODEL	MUO-1000 H	MUO-1000 S	MUO-2000 H	MUO-2000 S	MUO-3000 H	MUO-3000 S					
Capacity	1000VA / 900W		2000VA / 1800W		3000VA / 2700W						
INPUT											
Nominal voltage	208/220/230/240Vac										
Input voltage range	110~300Vac (176~280Vac @ 100% load)										
Power factor	≥0.99										
FREQUENCY											
Frequency range	40~70Hz (50/60Hz Auto-Sensing)										
OUTPUT											
Output voltage	208/220/230/240Vac										
Voltage regulation	± 1%										
Power factor	0.9										
Output frequency	Line Mode	46~54Hz or 56~64Hz									
	Bat. Mode	(50/60 ± 0.1%)Hz									
Crest factor	3:1										
Harmonic distortion (THDv)	≤3% Linear load										
	≤5% Non linear load										
Transfer time	AC mode to Bat.Mode	0ms									
	Inverter to Bypass	4ms (Typical)									
Output waveform	Pure Sinewave										
EFFICIENCY											
AC mode	88%		90%		91%						
Battery mode	85%		87%		88%						
BATTERY											
Battery number	2	3	2	3	4	6	4	6	6	8	6
Capacity (Standard unit)	9Ah/12V										
Typical recharging time	4 hours (to 90% of full capacity)										
Charging voltage	27.4Vdc ± 1%	41.1Vdc ± 1%	27.4Vdc ± 1%	41.1Vdc ± 1%	54.8Vdc ± 1%	82.2Vdc ± 1%	54.8Vdc ± 1%	82.2Vdc ± 1%	82.2Vdc ± 1%	109.6Vdc ± 1%	82.2Vdc ± 1%
Charging current (Max)	6A/12A		1A		6A/12A		1A		6A/12A		1A
INDICATORS											
LED display	Line mode, Bat.mode, ECO mode, Bypass mode, Battery low voltage, Overload & UPS fault										
LCD display	Input voltage, Input frequency, Output voltage, Output frequency, Load percentage, Battery voltage, Inner temperature & Remaining battery backup time										
ALARM											
Battery mode	Beeping every 4 seconds										
Battery low	Beeping every second										
Overload	Beeping twice every second										
Fault	Continuously beeping										
PHYSICAL											
Dimension W x D x H (mm)	144 x 293 x 209			144 x 399 x 209			191 x 460 x 337				
Net weight (kg)	4.1	9.3	12.5	10	19.5	24.5	10	24.5	10	24.5	24.5
ENVIRONMENT											
Operating temperature	0°C~40°C										
Storage temperature	-25°C~55°C										
Humidity range	20~95%RH @ 0~40°C (Non condensing)										
Altitude	<1500m, derating required when >1500m										
Noise level	<50dB at 1 Meter										
STANDARDS											
Safety	IEC/EN62040-1, IEC/EN62477-1										
EMC	IEC/EN62040-2, IEC61000-4-2, IEC61000-4-3, IEC61000-4-4, IEC61000-4-5, IEC61000-4-6, IEC61000-4-8										

Specifications are subject to change without prior notice.
When output voltage is 208Vac, need to derate to 80% of the unit capacity.